

ZCAMP PROJECT



Zcamp project in inner mongolia(Desert)



Zcamp project in inner mongolia(Steppe)



Zcamp project in Anhui(Cliff)



Zcamp project in Jiujiang ,Jiangxi(Lake)



Zcamp project in HeYuan, Guangdong(Riverside)



Zcamp project in Zhongshan, Guangdong(Waste land)



Zcamp project in Bazhong, Sichuan (Forest)



Zcamp project in Huaihua, Hunan(Seaside)

ABOUT ZCAMP

Zcamp Inc. is a high-end camping brand enterprise from California.

Zcamp brand adheres to the concept of hOme Everywhere, takes high-tech prefabricated house as the market entry point, leads the trend of high-end camp market, and explores more suitable lifestyle for Generation Z young people.

Zcamp moved to a new headquarters building covering a total area of about 200,000 square meters in Shunde, Foshan, and a 120,000 square meters of production base in Wuhu, Anhui Province, the monthly capacity can reach more than 300 units.

Zcamp as the biggest capsule house manufacturer in China, has 470+ domestic and abroad patents, global landing projects 500+, shipped to 36 countries.

The core team of Zcamp brand integrates the capabilities of camp planning and consulting, landscape planning, industrial design, interior design, making it the most comprehensive team in the camp accommodation industry and committing to becoming an excellent supplier of the global cultural and camping industry.



Foshan Zcamp Intelligent Equipment Co.,Ltd
www.zcamp.com 400-6055-111 info@zcamp.com

ADVANTAGES



DISTINCTIVE & CREATIVE DESIGN



EXPERT CAMPGROUND PLANNING



FAST & EASY INSTALLATION



SUITABLE FOR ANY TERRAIN

SCENARIOS





R5



Dimensions(L*W*H): 9.1* 3.2 *3.35 m
Building area: 29.1m²
Net weigh: ≈8 tons



R7



Dimensions(L*W*H): 11.5* 3.2 *3.35 m
Building area: 36.8m²
Net weigh: ≈9 tons



X5



Dimensions(L*W*H): 9.3* 3.2 *3.2 m
Building area: 29.8m²
Net weigh: ≈7 tons

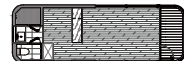

X7



Dimensions(L*W*H): 11.5* 3.2 *3.2 m
Building area: 36.8m²
Net weigh: ≈9 tons



E5



Dimensions(L*W*H): 8.5*3.3*3.2 m
Building area: 28.1m²
Net weigh: ≈7 tons



E7



Dimensions(L*W*H): 11.5* 3.3 *3.2 m
Building area: 38.0m²
Net weigh: ≈9 tons



A3



Dimensions(L*W*H): 5.6* 2.8 *3.0 m
Building area: 15.7m²
Net weigh: ≈5 tons



A5



Dimensions(L*W*H): 9.3*3.2*3.2 m
Building area: 29.8m²
Net weigh: ≈7 tons



A7



Dimensions(L*W*H): 11.5* 3.2 *3.2 m
Building area: 36.8m²
Net weigh: ≈9 tons



P5



Dimensions(L*W*H): 9.3* 3.2 *3.2 m
Building area: 29.8m²
Net weigh: ≈7 tons

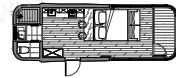

P7



Dimensions(L*W*H): 11.5* 3.2 *3.2 m
Building area: 36.8m²
Net weigh: ≈9 tons



K5



Dimensions(L*W*H): 8.5* 3.2 *3.2 m
Building area: 27.2m²
Net weigh: ≈7 tons



K7



Dimensions(L*W*H): 11.5* 3.2 *3.2 m
Building area: 36.8m²
Net weigh: ≈9 tons



V5



Dimensions(L*W*H): 7.5*3.3*3.2 m
Building area: 24.8m²
Net weigh: ≈6.5 tons



V7



Dimensions(L*W*H): 9.5*3.5*3.2 m
Building area: 33.3m²
Net weigh: ≈7 tons

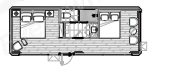

O5



Dimensions(L*W*H): 7.5*3.6*3.2 m
Building area: 27.0m²
Net weigh: ≈6.5 tons



H5



Dimensions(L*W*H): 9.1*3.3*3.35 m
Building area: 30.0m²
Net weigh: ≈8 tons



F7



Dimensions(L*W*H): 11.5*3.3*3.3 m
Building area: 38.0m²
Net weigh: ≈9.2 tons

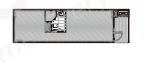

Z5



Dimensions(L*W*H): 9.3* 3.2 *3.2 m
Building area: 29.8m²
Net weigh: ≈7 tons



Z7



Dimensions(L*W*H): 11.5* 3.2 *3.2 m
Building area: 36.8m²
Net weigh: ≈9 tons



C3



Dimensions(L*W*H): 8.3*3.6*3.2 m
Building area: 29.9m²
Net weigh: ≈6 tons



C5



Dimensions(L*W*H): 9.2*3.6*3.2 m
Building area: 33.1m²
Net weigh: ≈7 tons



*The floor plan & pictures are for reference only.



ADD.: Lunjiao,Shunde,Foshan,Guangdong,China/ Xinwu Economic Development Zone,Wanzhi ,Wuhu ,Anhui,China



*The floor plan & pictures are for reference only.

ADD.: Lunjiao,Shunde,Foshan,Guangdong,China/ Xinwu Economic Development Zone,Wanzhi ,Wuhu ,Anhui,China

ADD.: Lunjiao,Shunde,Foshan,Guangdong,China/ Xinwu Economic Development Zone,Wanzhi ,Wuhu ,Anhui,China

ADD.: Lunjiao,Shunde,Foshan,Guangdong,China/ Xinwu Economic Development Zone,Wanzhi ,Wuhu ,Anhui,China